



# SETI

COMMERCIAL  
UNITS AVAILABLE





# **TWO GROUND FLOOR COMMERCIAL UNITS AVAILABLE AT SETL**

- \* UNIT A:  
45.8 M<sup>2</sup> / 493 FT<sup>2</sup>**
- \* UNIT B:  
171.8 M<sup>2</sup> / 1849 FT<sup>2</sup>**
- \* PRIME LOCATION  
ON LUDGATE HILL**
- \* SITUATED IN A NEW  
APARTMENT BLOCK**
- \* AVAILABLE FROM Q2 2024**





# PUT DOWN ROOTS IN THE JEWELLERY QUARTER



The Jewellery Quarter is the original creative neighbourhood, home to 700-jewellery makers, alongside indie shops, creative studios, and incredible restaurants, cafes and bars. At its centre is the beautiful St. Paul's Square – with Setl close by.





# GROUND FLOOR

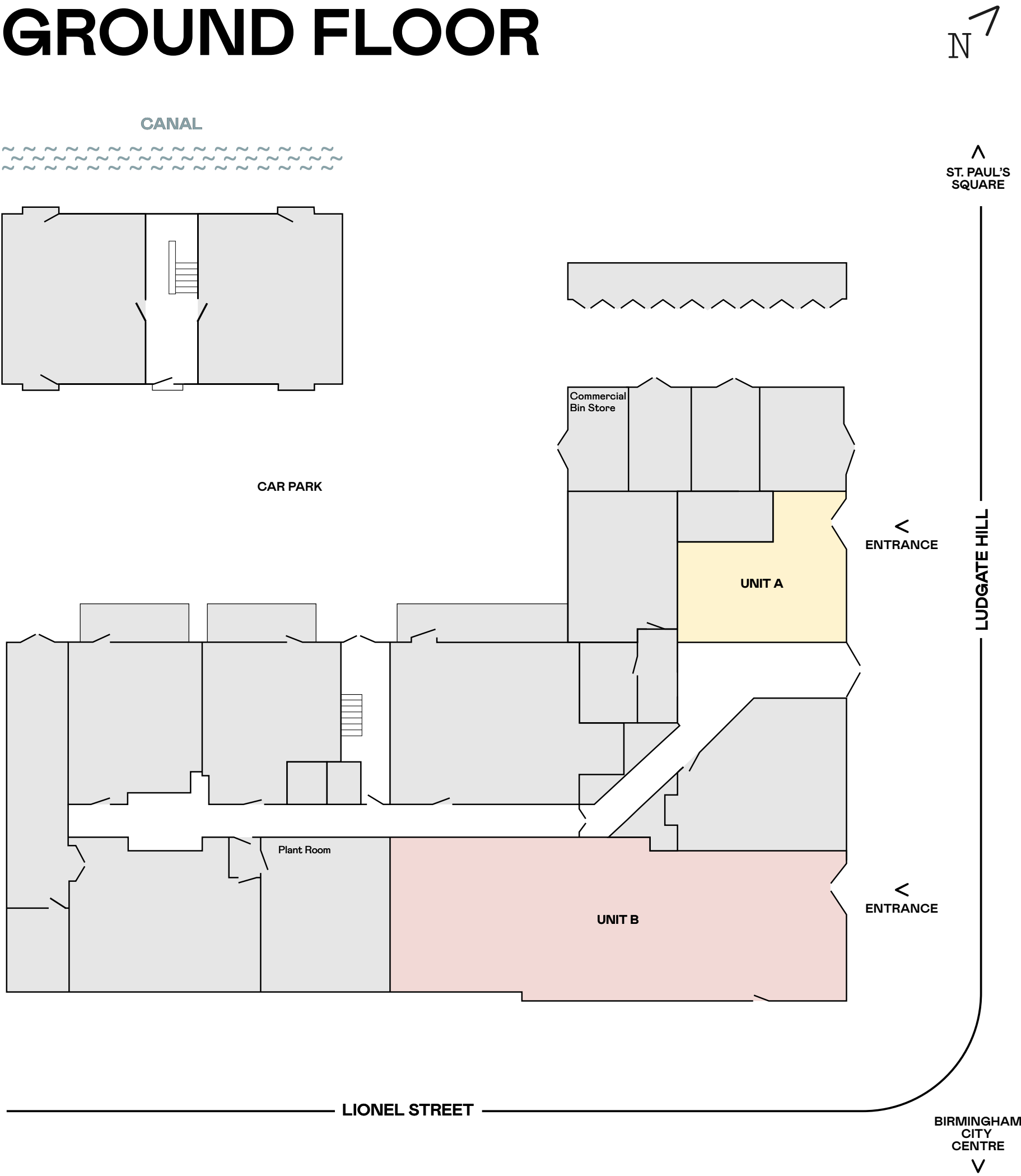

COMMERCIAL UNIT	AREA
Unit A	45.8 m <sup>2</sup> / 493 ft <sup>2</sup>
Unit B	171.8 m <sup>2</sup> / 1849 ft <sup>2</sup>

Disclaimer: Apartment sizes may vary and furniture is for illustration purposes only.



# FIND US

Setl, 50 Ludgate Hill,  
Birmingham, B3 1FG

setl.space

**CREATIVE RETAIL**  
PROPERTY CONSULTANTS

**0121 400 0407**

[www.creative-retail.co.uk](http://www.creative-retail.co.uk)

Ed Purcell  
07793 808974

**H B D**

PART OF HENRY BOOT GROUP